



Big Kid[®] Advanced/DLX Booster Seat

Owner's Manual
Keep for future use.

Child Requirements

13.6 to 49.8 kg
30 to 110 lbs

102 to 145 cm
40 to 57 inches

At least four years old

⚠️WARNING:

To reduce the risk of serious injury or death, read this owner's manual prior to installing and using this child restraint.

More children are killed every year as passengers in car crashes than by any other type of injury. To reduce the risk of **SERIOUS INJURY** or **DEATH**, read this owner’s manual and your vehicle owner’s manual before installing and using this child restraint. Using a child restraint makes a big difference. By properly using this child restraint and following these instructions (and the instructions that accompany your vehicle), you will greatly reduce the risk of serious injury or death to your child from a crash. Do not be misled by the commonly used term “safety seat;” no restraint system can prevent all injuries in all crashes. Many properly restrained adults and children are injured in motor vehicle crashes, including relatively minor crashes. A properly used child restraint is the best way to minimize injuries to your child and to increase the chances for your child’s survival in most crashes.

Table of Contents

U.S. Regulatory Notice..... 1

Symbol Legend.....1

Warnings 1

Safe Practices 4

Recall Information for U.S. Customers..... 5

Motor Vehicle/Aircraft Usage 5

Visual Glossary 6

Assembling Your Booster Seat 8

When to Put Your Child in a Booster Seat 12

Using Your Booster Seat with the Backrest14

Using Your Booster Seat Without the Backrest.....16

Adjusting the Backrest18

Removing the Backrest19

Using the Shoulder Belt Clip20

Using the Elastic Cup Holder.....21

Installing the Batteries.....22

Using the Activity Lights23

Using the Speakers23

Care and Cleaning..... 24

Replacement Parts25

Storing Your Instructions25

Limited Warranty26

U.S. REGULATORY NOTICE

This child restraint meets all applicable requirements of Federal Motor Vehicle Safety Standard 213.

Child Requirements

- No restraint can guarantee absolute protection from injury in every crash.
- To use this child restraint properly, children **MUST** meet weight/size specifications as follows:

With Backrest

- 13.6 to 49.8 kg (30 to 110 lbs)
- 102 to 145 cm (40 to 57 inches) tall
- Child is at least four years old.
- Ears below top of booster seat headrest

Without Backrest

- 18 to 49.8 kg (40 to 110 lbs)
- 102 to 145 cm (40 to 57 inches) tall
- Child is at least four years old.
- Ears below top of vehicle seat back

Symbol Legend



Airbag Symbol – Alerts you to important information about airbag safety.

WARNING

General Warnings

- Failure to follow each of the following instructions can result in your child striking the vehicle’s interior during a sudden stop or crash, potentially resulting in serious injury or death. These instructions and the instructions in your vehicle owner’s manual must be followed carefully. If there is a conflict between the two, the vehicle owner’s manual regarding booster seat installation must be followed.
- **NEVER** leave child unattended.
- In addition to the height and weight requirements, your child must be at least four years old to use this booster seat.

⚠ WARNING

Airbag Warnings

- **DO NOT** use this restraint in the front seat of a vehicle equipped with an air bag, unless the air bag has been deactivated. Air bags may cause serious injury or death to children 12 and under. If your vehicle has an air bag, refer to your vehicle owner's manual for child restraint installation.
- If the rear seat of your vehicle is equipped with side air bags:
Vehicles built prior to the 2002 model year:
DO NOT use this restraint in a vehicle seating position equipped with a side air bag unless authorized by the vehicle manufacturer.
Model year 2002 and newer vehicles: Refer to your vehicle owner's manual before placing this restraint in a seating position equipped with a side air bag.
- **DO NOT** place any objects between the restraint and the side air bag, as an expanding air bag may cause the items to strike your child.

IMPORTANT

The back seat is the safest place for children 12 and under.

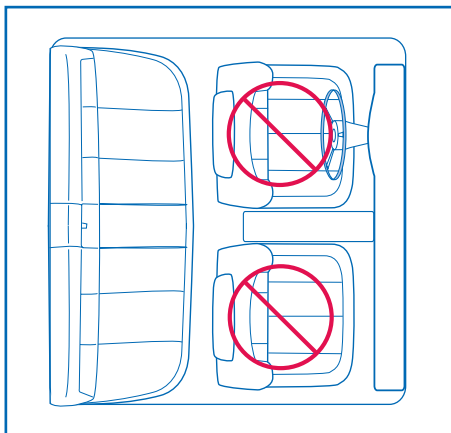

⚠ WARNING

Location Warnings

- According to statistics, children are safer when properly restrained in a rear seating position than in the front seating position. Children 12 and under should ride in the back seat of the vehicle.
- Use this booster seat only on forward-facing vehicle seats. **DO NOT** use this booster seat with vehicle seats that face the rear or side of the vehicle.
- Use this booster seat only on vehicle seats with backs that lock into place.
- Some booster seats do not fit in all vehicles. If the booster seat cannot be properly installed, **DO NOT** use the booster seat. Consult your vehicle owner's manual, try a different seating location, or call Evenflo at **1-800-233-5921** for further assistance.

Booster Seat Position Warnings

- **DO NOT** use this booster seat rear-facing.
- When using this booster seat, the headrest on the vehicle seat that the child faces should be put in its lowest position. The vehicle seat back that the child faces must be fully padded and free of any hard objects.

Seat Belt Warnings

- This booster seat may **NOT** be installed using lower universal anchorage systems (LATCH).
- This booster seat requires a vehicle seat belt with a lap and shoulder belt combination to be properly installed.
- **DO NOT** use this booster seat in a vehicle with door-mounted seat belts.
- **DO NOT** use this booster seat in a vehicle with seat belts that automatically move along the vehicle frame when the door is opened. These seat belts will not hold a booster seat properly.
- When using this booster seat, **NEVER** use a lap belt only. You **MUST** use vehicle seat belts that have a lap/shoulder combination.
- **DO NOT** use this booster seat if the child's ears are above the back of the booster seat.
- Failure to adjust the seat belts snugly around your child may result in your child striking the vehicle's interior during a sudden stop or crash. Serious injury or death may occur.



WARNING

Additional Warnings

- **DO NOT** use this booster seat if it has been involved in an accident. It must be replaced.
- **DO NOT** use this booster seat if it is damaged or has broken or missing parts.
- This booster seat must be securely belted to the vehicle at all times. An unsecured booster seat may injure someone if a crash occurs.
- Properly secure the hand-held music player (not supplied) in the storage pocket during travel. If a crash occurs, unsecured objects may act as projectiles and injure someone.
- **DO NOT** attach additional padding, toys, or other devices not made by Evenflo (other than the music player) to the booster seat. Items not tested with the booster seat could injure the child.
- In hot, sunny weather, cover the seat with a light colored blanket when you leave the vehicle. Always check the seat for hot surfaces before putting a child into the seat.
- **DO NOT** mix old and new batteries.
- **DO NOT** mix alkaline, lithium, standard (carbon-zinc), or rechargeable (nickel-cadmium) batteries.
- Remove batteries before storing unit for a prolonged period of time.
- **DO NOT** allow unit to get wet.

Safe Practices

- **Everyone rides buckled up or the vehicle does not go.** Make no exceptions for adults or children. If someone unbuckles, stop the vehicle. Being firm and consistent from the start will mean fewer discipline problems as children get older. An unrestrained person can be thrown into and injure other passengers.
- **NEVER** try to tend to a crying child's needs while driving. Never take a child out of a booster seat for comforting while the vehicle is moving.
- **DO NOT** allow a child to have objects such as lollipops or ice cream on a stick. These objects can injure the child if the vehicle swerves or hits a bump.
- Put sharp or heavy items in the trunk. Anything loose can be deadly in a crash.
- Leather (not available on all models) can become very hot in direct sunlight. Cover your booster seat with a blanket in warm weather.
- In cold weather a child may need an extra blanket for warmth. Put the child in the booster seat and cover both the child and the booster seat with a blanket.

Recall Information for U.S. Customers

- Child restraints could be recalled for safety reasons. You must register this restraint to be reached in a recall. Send your name, address, the restraint's model number, and manufacturing date to:
Evenflo Company, Inc.
1801 Commerce Dr.
Piqua, OH 45356
or call **1-800-233-5921**. You may also register online at **www.evenflo.com/registercarseat**.
- For recall information call the U.S. Government's Vehicle Safety Hotline at 1-888-327-4236 (TTY:1-800-424-9153), or go to **www.NHTSA.gov**.

Motor Vehicle/Aircraft Usage

When properly installed pursuant to these instructions, this restraint is certified for use only in passenger and multi-purpose passenger motor vehicles, buses, and trucks equipped with Type II seat belts.

This booster seat is **NOT** certified for aircraft use. A belt-positioning booster seat requires the use of a lap/shoulder belt system, which is not available on aircraft.

For future reference, record the **model number** of your child restraint **AND** the **date of manufacture** below.

Model Number: _____

Date of Manufacture: _____

Visual Glossary

Your vehicle may appear significantly different than pictured. Consult your vehicle's owner's manual to help identify your vehicle components.

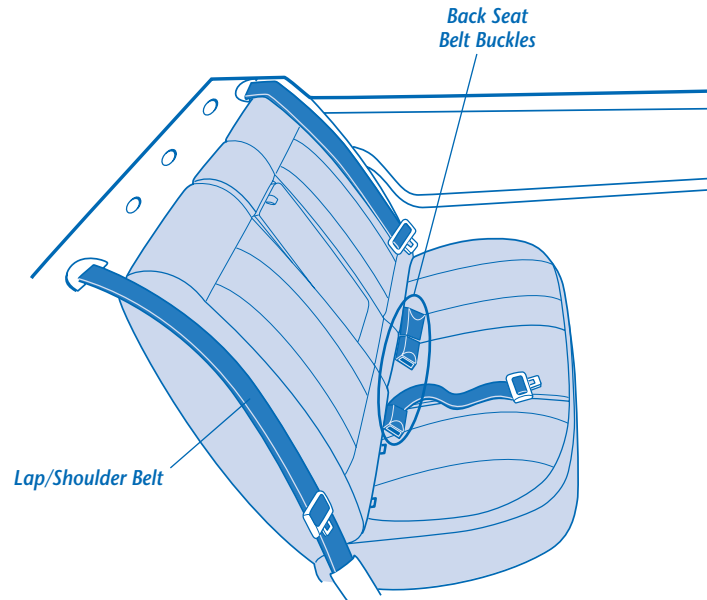

Visual Glossary

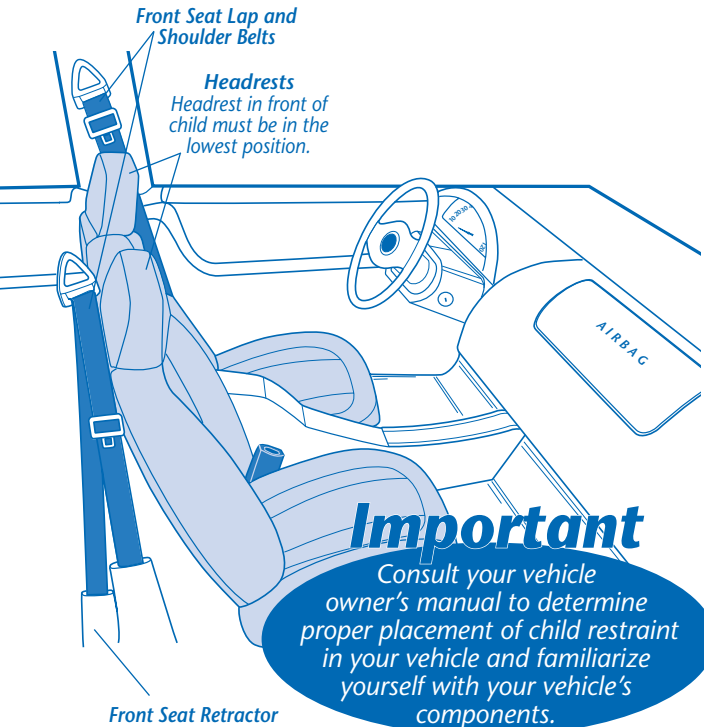

Front

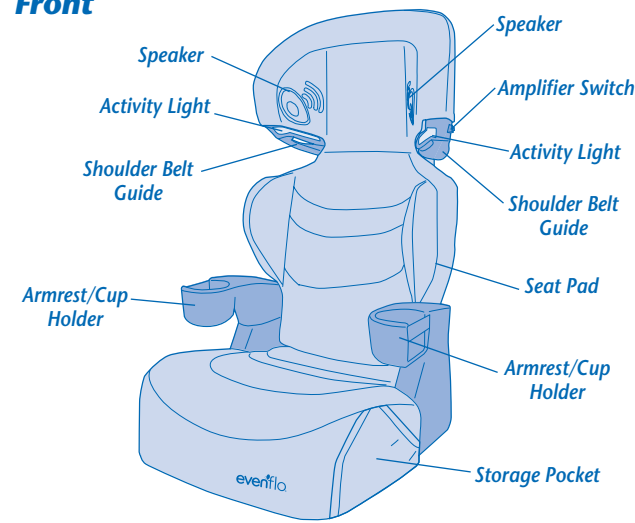

Back

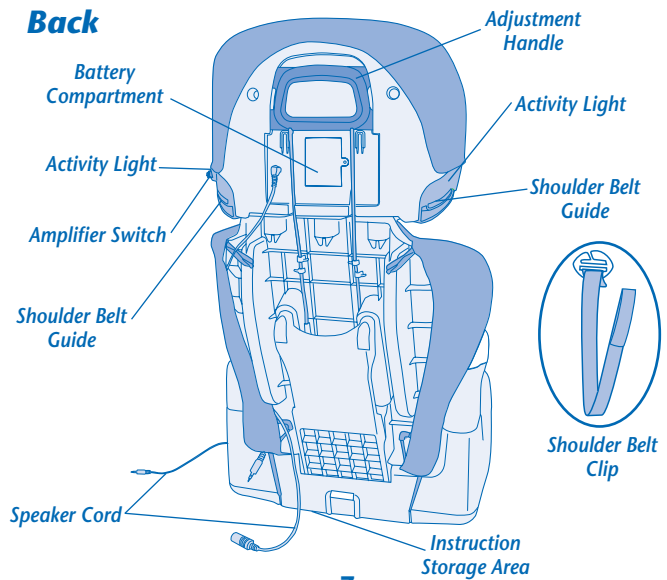

Assembling Your Booster Seat

- 1. Assemble the backrest.** Insert three posts **A** on the headrest **B** into the backrest **C**, as shown. Make certain the headrest locks securely into the backrest with an audible click.

Note: This is a one-time assembly and may require additional force to connect properly.

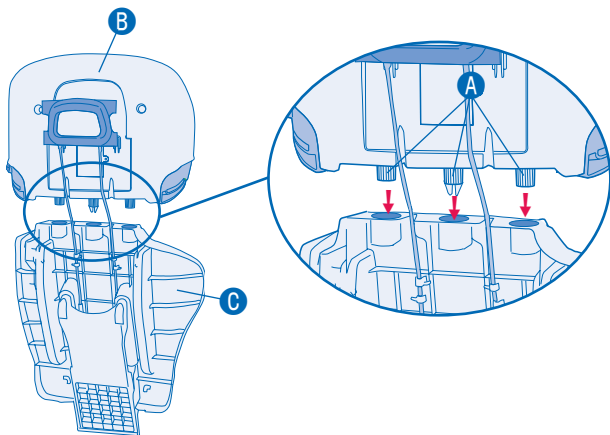

- 2. Install adjustment handle.** Align tabs **D** on adjustment handle **E** with the slots **F** on the back of the headrest. Press handle **E** against the back of the headrest and slide upward until the tabs **D** lock into place with audible clicks.

- 3. Attach the seat pad.** Connect seat pad straps to the hooks on the backrest assembly.

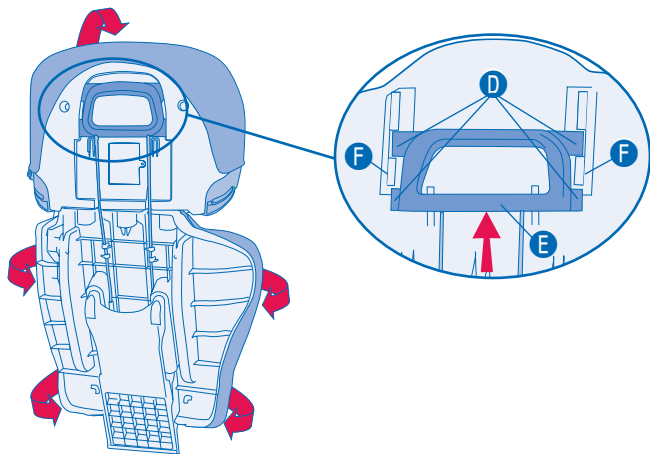

- 4. Extend the backrest adjuster.** Pull the adjustment handle **E** to unlock and fully extend the adjuster **G**.

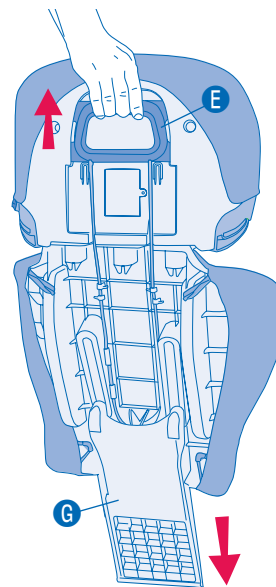

- 5. Install the backrest assembly to the base.** Slide the backrest adjuster **G** into the base **H**. Make certain the backrest locks into place with an audible click.

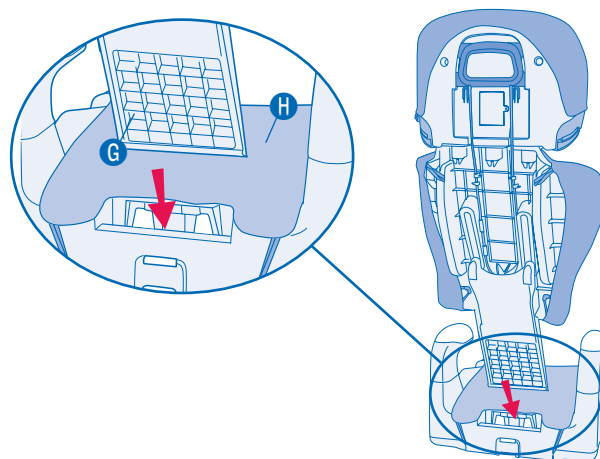

Assembling Your Booster Seat

This page is intentionally blank.

- 6. Connect the speaker cords.** Connect the speaker cord plug **I** on the upper part of the backrest to the jack **J** on the back of the headrest. Connect the other speaker cord plug **K** on the base to the jack **L** on the lower part of the backrest.

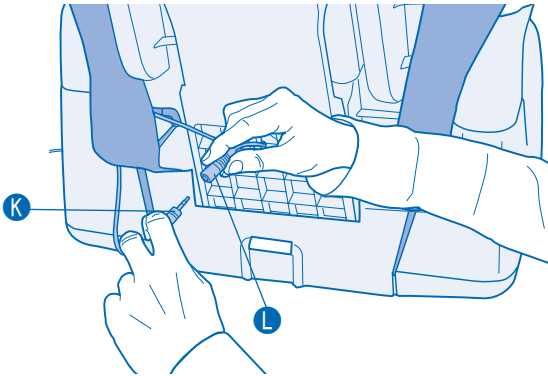
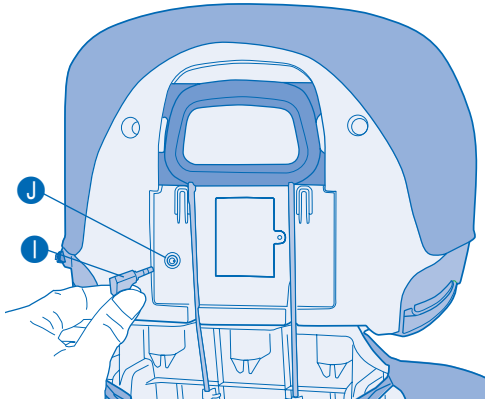

- 7. Check your work.** Inspect the booster seat to make sure the headrest is securely attached to the backrest, the seat pad is hooked into place, the backrest assembly is securely locked into the base, and the speaker cords are fully connected. Repeat any assembly steps as necessary.

When to Put Your Child in a Booster Seat

Booster seats raise the child up and help to position the vehicle lap and shoulder belt correctly. When the child is **properly restrained** in a booster seat, his/her risk of injury in all types of crashes is reduced, as the lap and shoulder belt provides excellent restraint of both the upper and lower torsos.

It is important for the child to sit properly within the vehicle seat belts. When the vehicle belt is buckled, the lap belt should be low on the hips, just touching the thighs, and the shoulder belt should lie across the middle of the shoulder. If the child leans out or moves the belt behind the back or places it under the arm, **it will not provide the intended restraint.**

There are a number of things to consider when deciding whether a child is ready to sit in a booster seat, including: the weight and height ratings on his/her current child seat, the child's own weight and height, his/her maturity, and the seating positions available in your vehicle.

How is a booster seat used?

Using a booster seat is very similar to buckling yourself into the vehicle:

- Read the instruction manuals for both the booster seat and the vehicle before you start.
- Put the booster in the back seat in a location with a lap and shoulder belt. **Never use a booster with only a lap belt**, as this could cause serious injuries.
- After the child is in the booster, pull the lap and shoulder belt across him/her and buckle it.
- Check that the shoulder belt lies across the middle of the shoulder and that the lap belt is low on the hips, just touching the thighs.

How can you tell if a child is ready to transition to a booster seat?

You should consider using a booster seat if the following conditions apply:

- The child is mature enough to sit in the booster seat and not put the belts under his/her arm or behind his/her back.
- The child is approaching the weight or height limit of the child restraint he/she is currently using. (Even children who have not outgrown their toddler seat can benefit from the use of a booster seat, if it is used properly.)
- If you have a vehicle that does not have a tether anchorage but has lap/shoulder belts available in the back seat, a booster seat may provide better protection than an internal harness seat without the tether.

*The shoulder belt **MUST** pass through shoulder belt guide.*

*The shoulder belt **MUST** cross midway between child's shoulder and neck.*

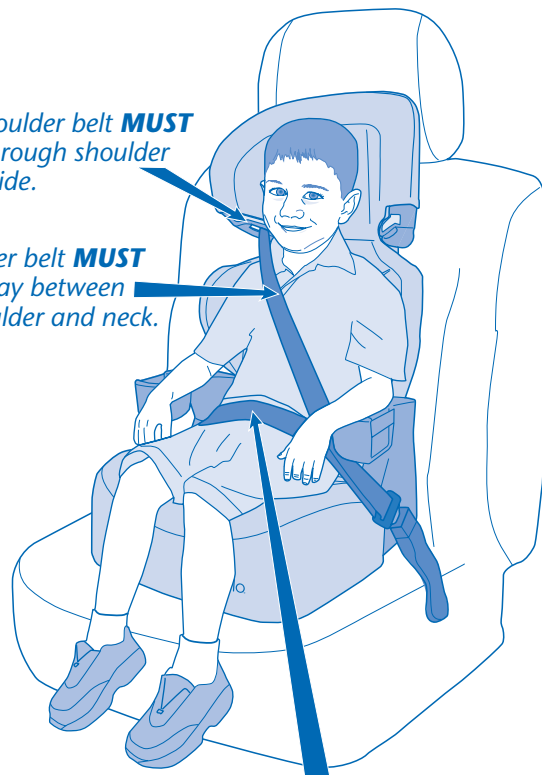

The lap belt is stretched low and snug across the child's hips, beneath the armrests, and fastened into the buckle.

Using Your Booster Seat with the Backrest

Child Requirements

Weight: 13.6 to 49.8 kg (30 to 110 lbs)

Height: 102 to 145 cm (40 to 57 inches)

Age: At least four years old

Ears below top of child restraint headrest



Installation Checklist

1. Place the booster seat on the vehicle seat.

2. Set the child in the booster seat.

Make sure the child's back and bottom are flat against the back and bottom surfaces of the booster seat.

3. Adjust the back of the booster, if necessary.

Adjust the backrest so the shoulder belt guides are level with the top of the child's shoulders. This will cause the shoulder belt to properly lay midway between the child's shoulder and neck (see Adjusting the Backrest, page 18).

⚠ WARNING

The shoulder belt **MUST NOT** cross the child's neck **or** fall off the child's shoulder. If you cannot adjust the shoulder belt to properly lay midway between the child's shoulder and neck, try another seating location or do not use the booster seat.



4. Secure the child and booster seat to the vehicle seat.

Stretch the lap/shoulder belt across the child and fasten the buckle. Make certain the shoulder belt is threaded through the shoulder belt guide.

5. Check your work.

Make sure the lap belt is stretched low and snug across the child's hips, beneath the armrests, and fastened into the buckle. The shoulder belt must cross the child midway between his/her shoulder and neck.

IMPORTANT

Always secure the booster seat with the vehicle seat belts when not occupied. An unsecured booster seat can fly into and injure other occupants in the event of a crash.

Using Your Booster Seat Without the Backrest

Child Requirements

Weight: 18 to 49.8 kg (40 to 110 lbs)

Height: 102 to 145 cm (40 to 57 inches)

Age: At least four years old

Ears below the top of the vehicle headrest

The shoulder belt **MUST** cross midway between child's shoulder and neck. Use belt clip, if necessary.

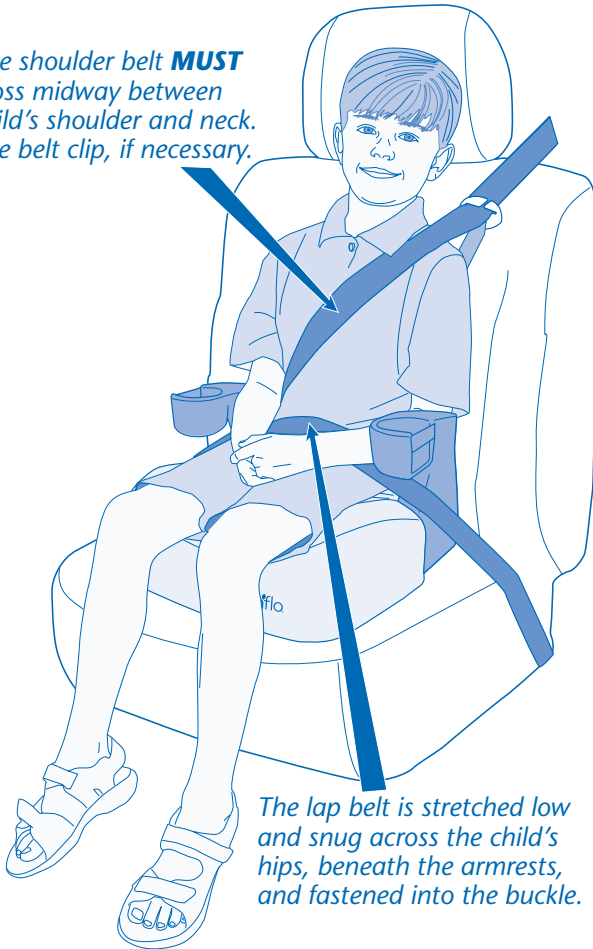

The lap belt is stretched low and snug across the child's hips, beneath the armrests, and fastened into the buckle.

Installation Checklist

1. **Remove the backrest from the booster seat.**
(See Removing the Backrest, page 19.)
2. **Place the booster seat on the vehicle seat.**
3. **Set the child in the booster seat.**
Make sure the child's back is flat against the vehicle seat and the child's bottom is flat against the booster seat.
4. **Secure the child and booster seat to the vehicle seat.**
Stretch the lap/shoulder belt across the child and fasten the buckle.
5. **Use the shoulder belt clip, if necessary.**
If the shoulder belt does not properly lay midway between the child's shoulder and neck, attach and adjust the belt clip (see Using the Shoulder Belt Clip, page 20).

⚠ WARNING

The shoulder belt **MUST NOT** cross the child's neck **or** fall off the child's shoulder. If you cannot adjust the shoulder belt to properly lay midway between the child's shoulder and neck, try another seating location or do not use the booster seat.



6. **Check your work.**
Make sure the lap belt is stretched low and snug across the child's hips, beneath the armrests, and fastened into the buckle. The shoulder belt must cross the child midway between his/her shoulder and neck.
Note: If the vehicle's shoulder belt naturally crosses the child's shoulder, you do not need to use the shoulder belt clip.

IMPORTANT

Always secure the booster seat with the vehicle seat belts when not occupied. An unsecured booster seat can fly into and injure other occupants in the event of a crash.

Adjusting the Backrest

To adjust the backrest **A**, pull and hold the adjustment handle **B**, then slide the backrest up or down. The backrest is positioned properly when the bottom of the shoulder belt guides are even with the top of child's shoulders.

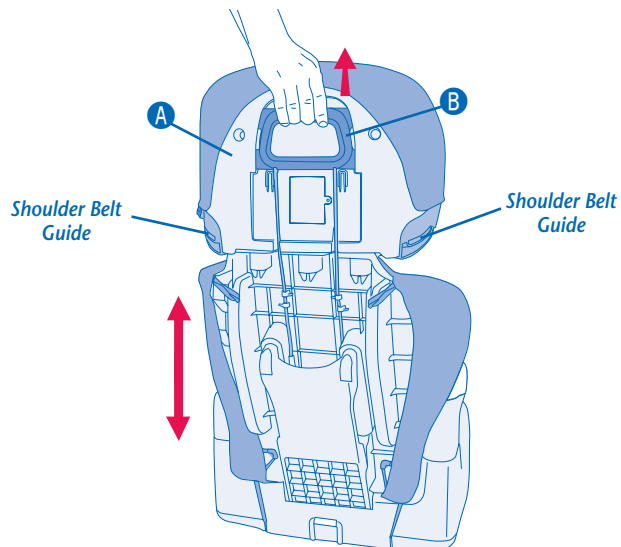

Removing the Backrest

1. Lay the booster seat on its side.
2. Disconnect the speaker cord plug on the base from the jack on the lower part of the backrest (see page 10). (You will now be unable to use the speakers.)
3. Squeeze the lever **A** on the bottom of the base **B** and remove the backrest **C** from the base.

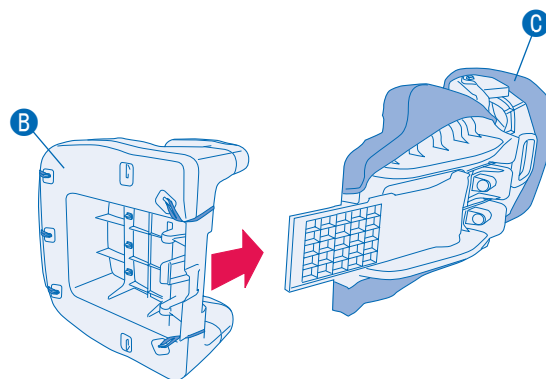
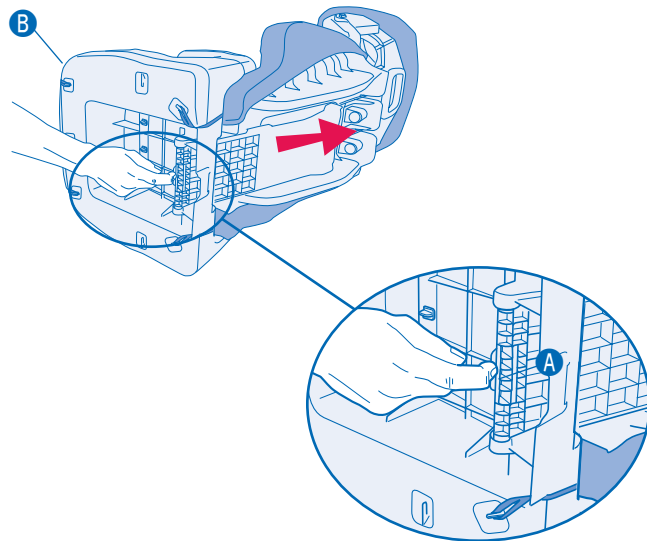

IMPORTANT

Store the backrest properly when not in use. Any loose objects can become projectiles and injure someone during a crash.

Using the Shoulder Belt Clip

1. Thread the looped end of the shoulder belt clip belt **A** through the anchor point on bottom of the booster **B**.
2. Thread the shoulder belt clip **C** through the loop at the end of the belt **A** and pull until tight.

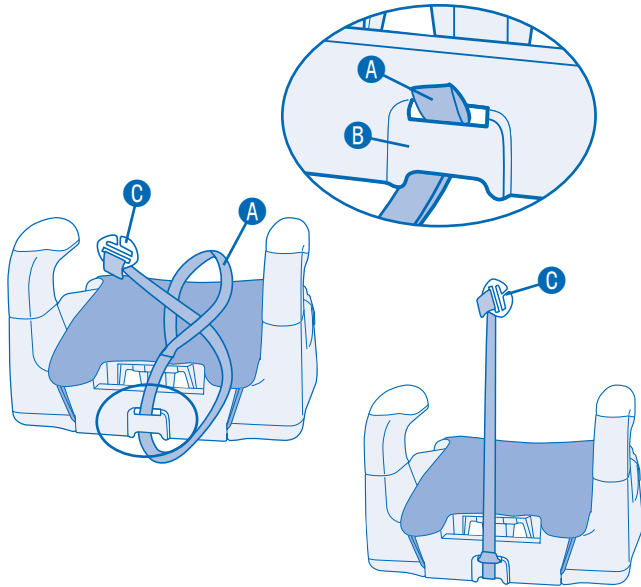

3. Place booster **B** on the vehicle seat and attach the shoulder belt clip **C** to the vehicle shoulder belt **D**.
4. Pull the adjustment strap **E** until belt clip **C** is even with the child's shoulder, and the vehicle shoulder belt **D** lays across the child's chest midway between his/her shoulder and neck.

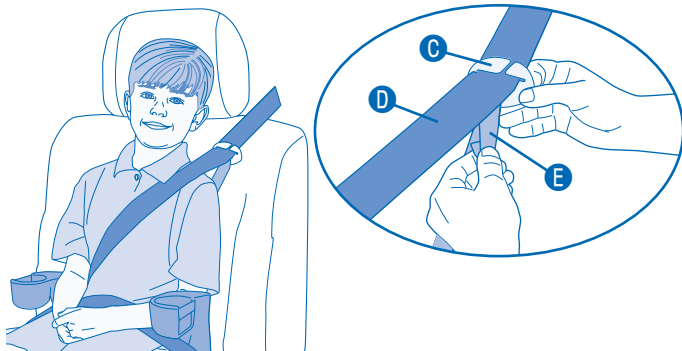

Using the Elastic Cup Holder

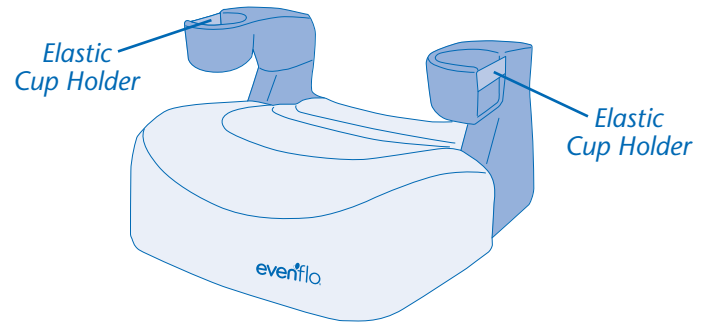

⚠ WARNING

- **DO NOT** use the cup holder to store cans, bottles, or hard containers. Only for use with soft cups (such as styrofoam or paper).
- **DO NOT** place any cups that contain hot liquids (such as coffee or tea) in the cup holder.
- **DO NOT** attach additional padding, toys, or other devices to the booster seat. Items not tested with the booster seat could injure the child.

Installing the Batteries

⚠ WARNING

- **DO NOT** mix old and new batteries.
- **DO NOT** mix alkaline, lithium, standard (carbon-zinc), or rechargeable (nickel-cadmium) batteries.
- Remove batteries before storing unit for a prolonged period of time.
- **DO NOT** allow unit to get wet.

To install batteries for the activity lights and speakers, remove screw **A** and battery door **B**, install batteries as shown, then replace battery door and screw. For best performance, Evenflo recommends installing new lithium batteries.

Note:

- If the activity lights dim while music is playing through the speakers, your batteries may need to be replaced.
- To prolong battery life, do not use the speakers and the lights at the same time. Doing so will drain the batteries more quickly.
- Dispose of old batteries properly.

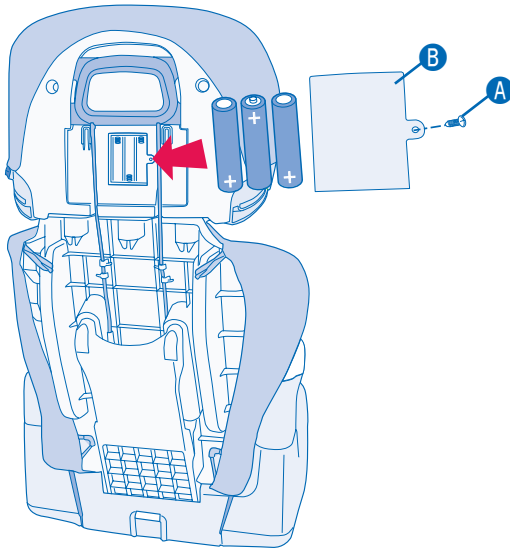

Using the Activity Lights

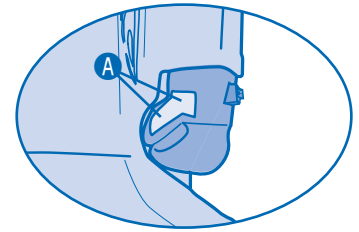
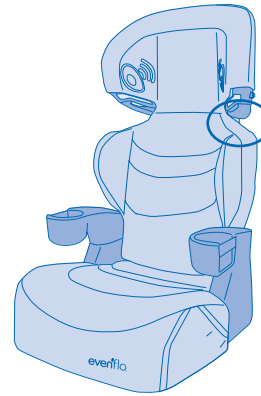

Press either of the two activity lights **A** on each side of the headrest to turn on or off.

Using the Speakers

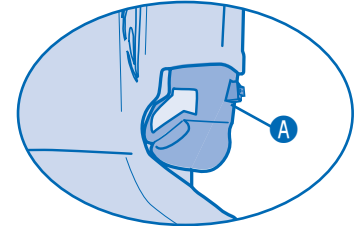
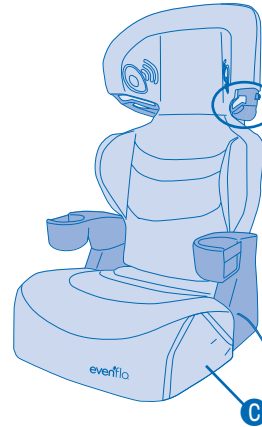

1. Press the amplifier switch **A** on the left side of the headrest to turn the amplifier on.
2. Connect the speaker cord plug **B** on the left side of the base to the headphone jack on the hand-held music player (not supplied) you intend to use.

Note: The booster seat does not have control of music volume. Music volume can be controlled only by adjusting the volume level on the music player.

⚠ WARNING

Properly secure the hand-held music player in the storage pocket **C** during travel. If a crash occurs, an unsecured music player may act as a projectile and injure someone.

Care and Cleaning

- Plastic parts may be wiped clean with mild soap and water and dried with a soft cloth. Do not use abrasive cleaners or solvents.
- Take care not to damage any labels.
- **Note:** Remove speaker cord prior to washing the seat pad. Machine wash the seat pad (except for leather seat pads—not available on all models) separately in cold water, delicate cycle, and tumble dry 10 to 15 minutes on low heat.
- Never use booster seat without the seat pad.
- To help protect the vehicle upholstery, place a towel beneath and behind the booster seat.

Proper Disposal of This Child Restraint

At the end of this child restraint's useful life, Evenflo encourages you to dispose of it properly. Most of the components in this child restraint are recyclable.

1. Remove all fabric and padding.
 2. Remove all screws and disassemble the restraint.
 3. Recycle all plastic/foam parts and discard the rest.
- If your local recycling center won't accept the padding, you may dispose of it in the landfill.

Note: Evenflo uses recycled materials in the manufacturing process whenever possible but never for components that are critical for safety.

Replacement Parts

Not available on all models.

You can order replacement parts online at www.evenflo.com or contact Evenflo at 1-800-233-5921. When you contact us, please have the product model number and date of manufacture (found on the bottom of the child restraint).

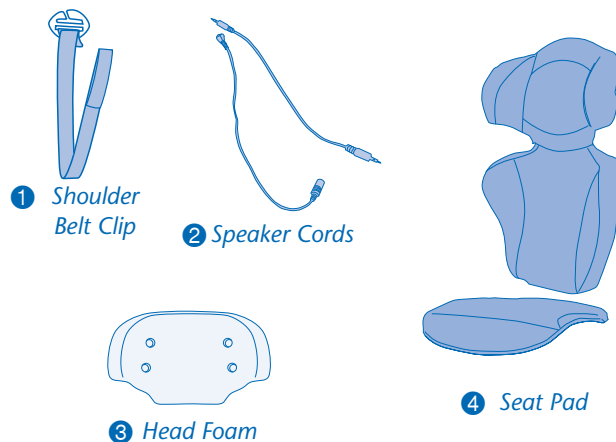

Storing Your Instructions

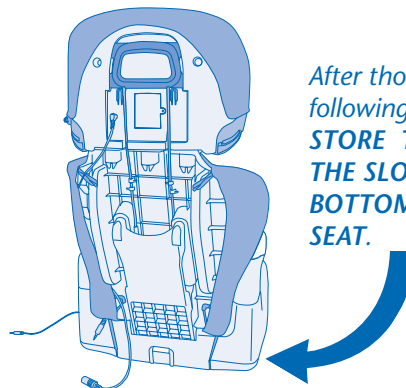

After thoroughly reading and following these instructions, **STORE THE INSTRUCTIONS IN THE SLOTS PROVIDED ON THE BOTTOM OF THE BOOSTER SEAT.**

Limited Warranty

For a period of 90 days from the original purchase of this Product, Evenflo warrants to the original end user (“Purchaser”) this Product (including any accessories) against defects in material or workmanship. Evenflo’s sole obligation under this express limited warranty shall be, at Evenflo’s option, to repair or replace any Product that is determined to be defective by Evenflo and determined to be covered by this warranty.

Repair or replacement as provided under this warranty is the exclusive remedy of the Purchaser. Proof of purchase in the form of a receipted invoice or bill of sale evidencing that the Product is within the warranty period must be presented to obtain warranty service. This express limited warranty is extended by Evenflo ONLY to the original Purchaser of the Product and is not assignable or transferable to subsequent purchasers or end users of the Product. For warranty service, contact Evenflo’s Parent-Link Consumer Resource Center at **1-800-233-5921** or **www.evenflo.com**.

EXCEPT TO THE EXTENT PROHIBITED BY APPLICABLE LAW, ANY IMPLIED WARRANTY OF MERCHANTABILITY OR FITNESS FOR A PARTICULAR PURPOSE ON THIS PRODUCT IS HEREBY DISCLAIMED. EVENFLO SHALL NOT BE LIABLE FOR ANY INCIDENTAL, CONSEQUENTIAL, SPECIAL OR PUNITIVE DAMAGES OF ANY KIND FOR BREACH OF THE EXPRESS LIMITED WARRANTY ON THIS PRODUCT, OR ANY WARRANTY IMPLIED BY OPERATION OF LAW. OTHER THAN THE EXPRESS LIMITED WARRANTY SET FORTH ABOVE, THERE ARE NO OTHER WARRANTIES THAT ACCOMPANY THIS PRODUCT AND ANY ORAL, WRITTEN OR ANY OTHER EXPRESS REPRESENTATION OF ANY KIND IS HEREBY DISCLAIMED.

ParentLink®

answers. advice. affirmation.™

• **www.evenflo.com**

• **USA: 1-800-233-5921, 8 AM to 5 PM E.T.**

ParentLink®

answers. advice. affirmation.™

• **www.evenflo.com**

• ***USA: 1-800-233-5921, 8 AM to 5 PM E.T.***