

Adventure Booster

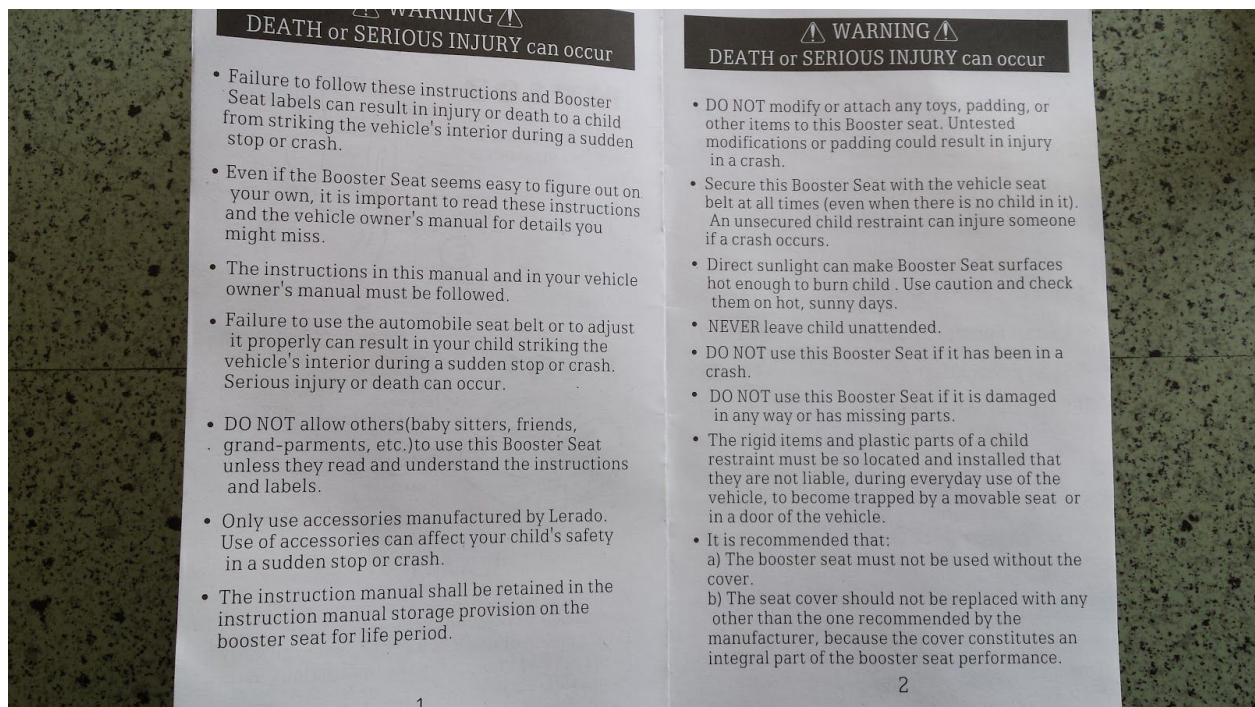

Booster Seat Parts

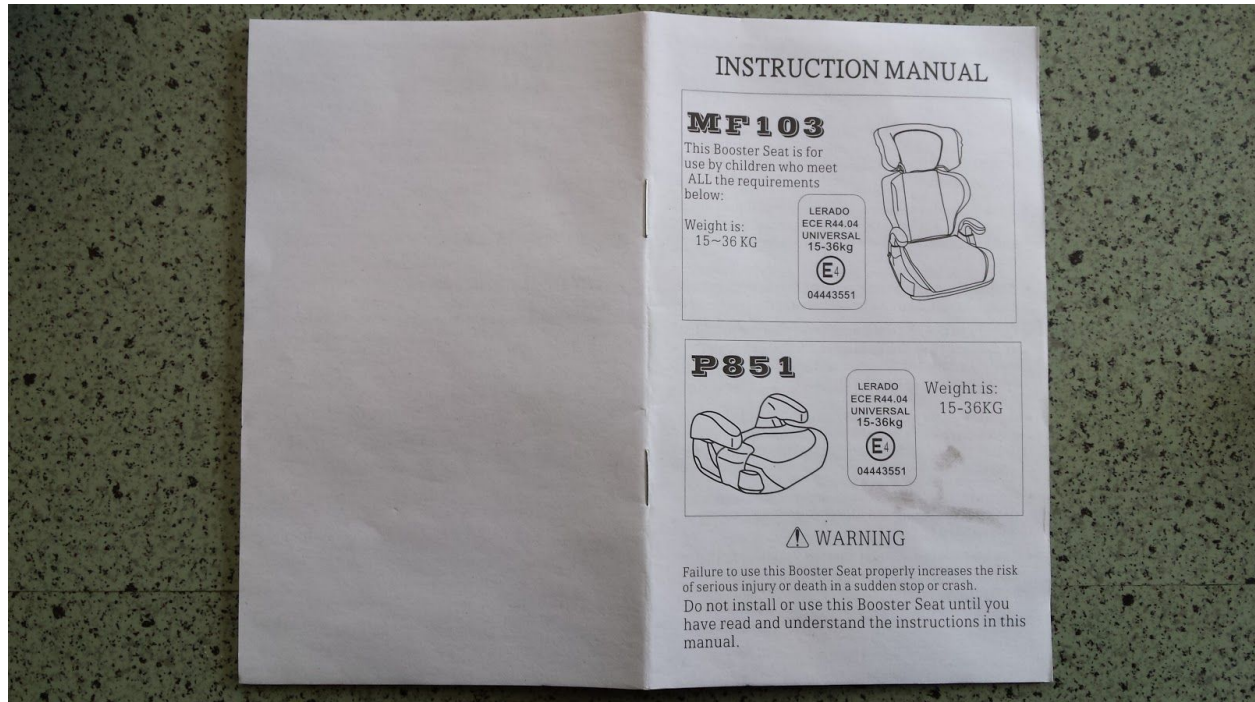

Seat Base



Headrest



Seat Back

5

Assemble Booster seat

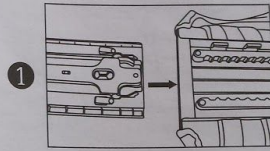

1. Assemble Headrest and Seat Back together

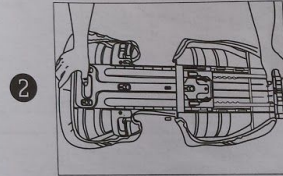

2. Pull up the Height Adjustment Lever on the Headrest back and push Headrest into Seat Back.

6

Assemble Booster seat

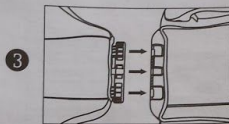

3. Connect the Seat Back to the Seat Base.

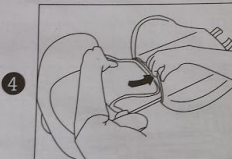

4. Put the underpart of Headrest into Seat Back

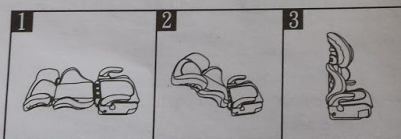

5. Press Seat Base, lift up the Headrest, then hear "Click", assembly finish.

7

Use the Booster Seat

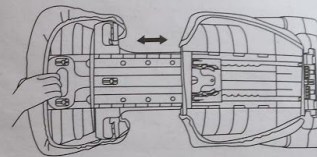

8

Use the Booster Seat

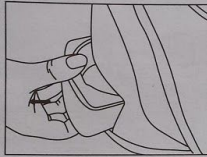

3. Using the Cup Holder:

-To use:

Simply pull the Cup Holder out to one side into its "Locked" position.

-To store:

Push the Cup Holder into its Stowage tray.

The Cup Holder will hold Cups, Cans or Small drink cartons.

⚠ WARNING:

DO NOT place Pencils or other Sharp pointed Objects into Cup Holders. Similarly, to Avoid burns or scalds, NEVER Put hot liquids into Cup Holder.

Vehicle Seats Location

- Use only the vehicle's lap and shoulder belt system when restraining a child in this Booster Seat.
- NEVER use the Booster Seat with the vehicle's Child Restraint Anchorage System or LATCH System.
- DO NOT use this Booster Seat with vehicle seat belts mounted to front door.
- DO NOT use this Booster Seat if it cannot be properly installed. Some child restraints will not fit some vehicle seating positions.
- NEVER use this Booster Seat in any vehicle seating position equipped with an active air bag unless recommended by the vehicle manufacturer.
- DO NOT use this Booster Seat in rear seat of a compact pickup truck. Severe head injury or death can occur.
- The rigid items and plastic parts of the booster seat must be so located and installed that they are not liable, during everyday use of the vehicle, to become trapped by a movable seat or in a door of the vehicle

Vehicle Seats Location

⚠ WARNING:

IMPROPER PLACEMENT OF THE BOOSTER SEAT INCREASES THE RISK OF SERIOUS INJURY OR DEATH.

Some seating positions in your vehicle may NOT be safe for this Booster Seat. Some vehicles do not have any seating positions that can be used safely with the seat. If you are not sure where to place the Booster seat in your vehicle, consult your Vehicle owner's manual.

DO NOT use this Booster Seat with the following vehicle seats:



Seats Which Face Sides Of Vehicle



Seats Which Face Rear Of Vehicle

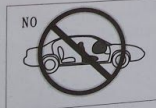

DO NOT USE THE BOOSTER SEAT IN ANY VEHICLE SEAT WHERE AN AIRBAG IS FITTED.

Vehicle Seats Location

Children are safer when properly restrained in rear vehicle seating positions. Whenever possible, secure the Booster Seat in the center position of the seat directly behind the front seats. This position, however, is often equipped with a lap belt only and, if so, MUST NOT be used.

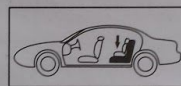

Vehicle Seats Position

The Vehicle's Seat **MUST** be Positioned Correctly and Safely. The vehicle's seat headrest must Not interfere with the Booster Seat's Headrest. The Front of the Booster Seat Base **MUST NOT** hang over front of Vehicle seat.

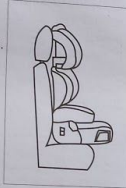

The back of the Booster Seat **MUST** fit tightly against the Vehicle's seat as shown:

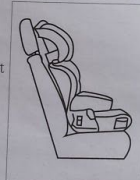

13

Install Booster Seat

- Use only a vehicle lap and shoulder belt system when restraining the child in this Booster Seat.
- Snugly adjust the vehicle lap and shoulder belt around your child according to the instructions in the vehicle owner's manual.
- **DO NOT** allow child to slide down in Booster Seat which could position vehicle lap belt across child's abdomen and shoulder belt over neck or face.



Adjusting Lap and Should belt:

- 1-Place Lap and Should belt Across the front of the child And buckle-up the seat belt.
- 2-Position the Lap belt under both Armrests.
- 3-Place the Should belt over child's chest and into the Booster Seat's Should belt Guide.



4. NOTE: Adjust the Headrest and Armrest Once child is properly seated.

14

Install Booster Seat

- **DO NOT** use this Booster Seat when the child's shoulders are above the shoulder belt guide with headrest in highest position.
- **DO NOT** use this Booster Seat if the vehicle shoulder belt lays Across child's neck, head or face. Severe head or neck injuries can be resulted from improper head support.

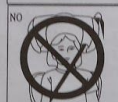
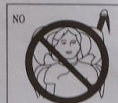

⚠ Warning:

It is recommended that any straps holding the booster seat to the vehicle should be tight, that any straps restraining the child should be adjusted to the child's body, and that straps should not be twisted.

2. The booster seat is only suitable for use in the vehicles fitted with 3 point safety-belts which approved to ECE Regulation No. 16 or other equivalent standards.

15

Install Booster Seat Base

Remove the Seat Back, the Seat Base can be used for the child WHO must meet ALL of the Following requirements:

- Age is: 4~10 years old
- Weight is: 15~36 KG and
- Height is: 101~145 cm
- Whose ears are below top of vehicle seat



Use the Seat Base:

1. Remove the elastic cord which fix the rear part of Seat Base Pad.
2. Take out of the additional cover from the pad of Seat Base.



3. Fix the cover and Seat Base Pad. This Cover can increase the safety for Child.



16

Install Booster Seat Base

Adjusting Lap and Should belt:

1-Place Lap and Should belt Across the front of the child And buckle-up the seat belt.

2-Position the Lap belt under both Armrests and low on the child's hips just touching the thighs.

3-Place the Should belt over child's chest and across the top of child's shoulder.

4. NOTE: Adjust the Armrest Once child is properly seated.



Aircraft use

⚠ WARNING:

This Booster Seat is NOT certified for use in an Aircraft because there are not shoulder straps available in an Aeroplane.

17

Safety checklist

-Did you read and understand these instructions in this Instruction Manual and also the warning labels on the seat?

-Is the Child of the correct weight and height for the Booster Seat or Seat Bases

-CHECK>>>WARNING! The Booster Seat or Seat Base MUST NOT be used in a seat with an AIRBAG.

-Is Booster Seat or Seat Base facing forward on a vehicle's seat That is fitted with a lap AND a shoulder belt?

-Is the child secured in the rear seat?

-Is Vehicle seat belt properly secured and snugly adjusted Around the Booster Seat and around your children?

CHECK-Lap belt under armrest?

CHECK-Shoulder belt in the Booster seat's shoulder belt guide?

CHECK-Shoulder belt guide at or about child's shoulders?

CHECK-Child is sitting up straight with lap belt low and contacting things?

CHECK-Shoulder belt is contacting chest and correctly Positioned on child's shoulder?

-Is the weather hot and sunny? CHECK For hot surface!

18

Safety checklist

-EVERYONE riding in the vehicle MUST wear a seat belt. It is the law! Make sure all passengers are buckled up or the Vehicle does not go. Make NO EXCEPTIONS for adults or for Children.

CHECK-If someone unbuckles, the vehicle STOPS! Being Firm and consistent will result in fewer discipline.

Problems with vehicle safety as the children grow older in the event of an accident, an unrestrained person can Be thrown onto and injure other passengers.

-Snugly adjust the lap and shoulder belt around the child.

-Vehicle lap belt MUST be low on the abdomen, contacting the child's thighs. The shoulder belt MUST be centered on the Chest and over shoulder. NOT on the child's face, neck or arm.

-DO NOT allow the child to slide down under the lap belt or put the shoulder belt under their arm or behind their back.

-DO NOT allow a child to have lollipops, Ice-lollies or other Food-on-stick. The stick could injure the child in the event of a Sudden stop or a crash.

-Collect together and put all heavy or sharp items in the car Boot. Loose items can fly around and be deadly in a crash.

19

Safety checklist

-NEVER Take a child out of the Booster Seat or Seat Base while the vehicle is moving.

-NEVER try to deal with a child's needs while driving.

NOTICE:

1-This is a "Universal" child restraint. It is for general use in Vehicles and it will fit most. But not for all car seat.

2-A correct fit is Likely if the vehicle manufacturer has declared in the vehicle hand Book that the vehicle is capable of accepting a "Universal" child Restraint for this age group.

3-This child restraint has been classified As "Universal" under more stringent conditions than those which Applied to earlier designs which do not carry this notice.

DO NOT USE THIS BOOSTER SEAT OR SEAT BASE IN ANY VEHICLE SEAT WHERE AIRBAG IS FITTED.

20

Care and Manitenancve

-CLEANING METAL AND PLASTIC PARTS-Sponge clean with mild soap and cool water. NEVER CLEAN with ammonia OR bleach based. OR spirit-type cleaners.

DO NOT Spin, Drip dry only.

DO NOT USE BLEACH.

-DO NOT USE THIS BOOSTER SEAT without its cover

-FORM TIME-TO-TIME CHECKING THE SEAT for worn parts, torn material and stitching. If damage is found, DO NOT try to modify the Booster Seat, Replace the Booster Seat.

Manufacturer:

LERADO CHINA LTD

MADE IN CHINA

Table Of Contents

1. Booster seat parts	4~5
2. Assemble Booster Seat	6~7
3. Use the Booster Seat	8~9
4. Vehicle seat location	10~12
5. Vehicle seat position	13
6. Install Booster Seat	14~15
7. Install Booster Seat Base	16~17
8. Safety checklist	18~20
9. Care and Maintenance	21

Booster Seat Parts

